

# PRORIL

60Hz

Designed for light weight, excellent performance, low energy consumption, and easy maintenance, PRORIL submersible handy pumps serve a wide range of pumping applications on utility, construction, industrial, and municipal job sites.

## Handy and Residue Pump

# SMART LITE 400/750

Handy Pump



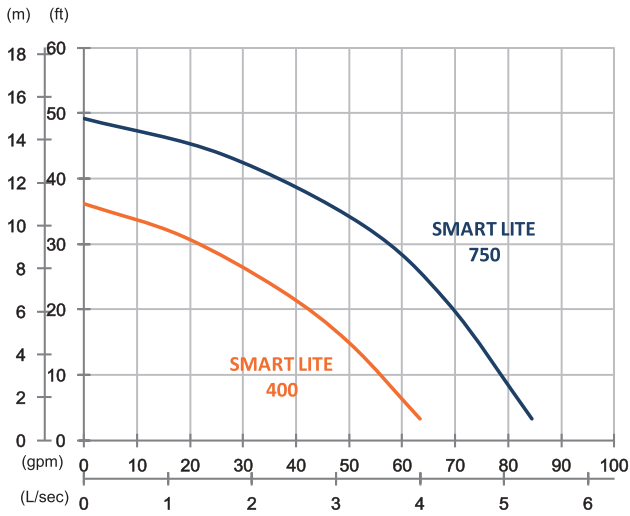

	SMART LITE 400	SMART LITE 750
<b>OUTPUT</b>	0.5 HP (0.4 kW)	1 HP (0.75 kW)
<b>OUTLET</b>	2" (50 mm)	2" (50 mm)
<b>SOLID PASSAGE</b>	0.3" (7 mm)	0.3" (7 mm)
<b>Weight</b>	25 lbs/11 kg	29 /lbs13 kg
<b>HEAD</b>	Rated: 23 ft, 7 m Max: 36 ft, 11 m	Rated: 33 ft, 10 m Max: 49 ft, 15 m
<b>FLOW</b>	Rated: 37 gpm, 2.3 L/s Max: 63 gpm, 4 L/s	Rated: 53 gpm, 3.3 L/s Max: 85 gpm, 5.3 L/s

<b>Pump Type</b>		Electric Submersible Pumps
<b>Motor</b>	<b>Phase</b>	1-Phase, 3-Phase
	<b>Type</b>	Induction Motor
	<b>Poles</b>	2 Pole (3450 rpm)
	<b>Insulation</b>	Class F
	<b>Protector</b>	Miniature Thermal Protector Circle Thermal Protector
	<b>Starter</b>	1-Phase • Capacitor-Run, 3-Phase • D.O.L
<b>Lubricant</b>		Food Grade (ISO VG32)
<b>Specs.</b>	<b>Impeller Type</b>	Semi-Vortex
	<b>Shaft Seal</b>	Double Mechanical Seal
		Silicon Carbide VS Ceramic/Carbon
	<b>Bearings</b>	C3 Shielded ball bearings
	<b>Cable</b>	CSA-Certified PVC Jacketed Cables
33 ft (10 m) or longer upon request		
<b>Materials</b>	<b>Pump Casing</b>	Gray Iron
	<b>Impeller</b>	Synthetic Polymers
	<b>Motor Frame</b>	Aluminum
	<b>Motor Shaft</b>	Stainless Steel
	<b>Outer Case</b>	Aluminum
	<b>Strainer</b>	Carbon Steel
<b>Max. Liquid Temperature</b>		40°C (104°F)
<b>Max. Submersion Depth</b>		20 m (66 ft)
<b>pH Range</b>		pH 5 - pH 8

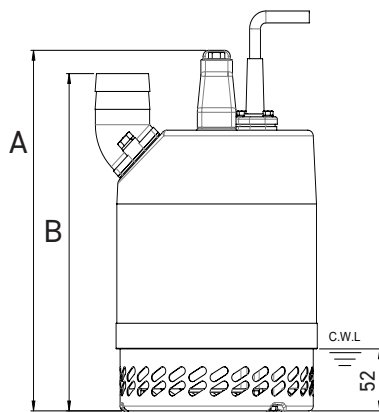
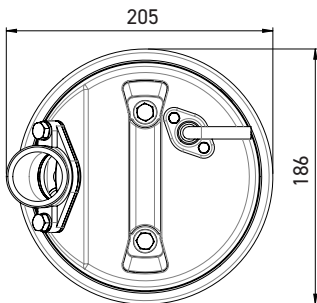

	A	B
SMART LITE 400	303	283
SMART LITE 750	343	323

unit : mm

C.W.L. : Continuous running water level